

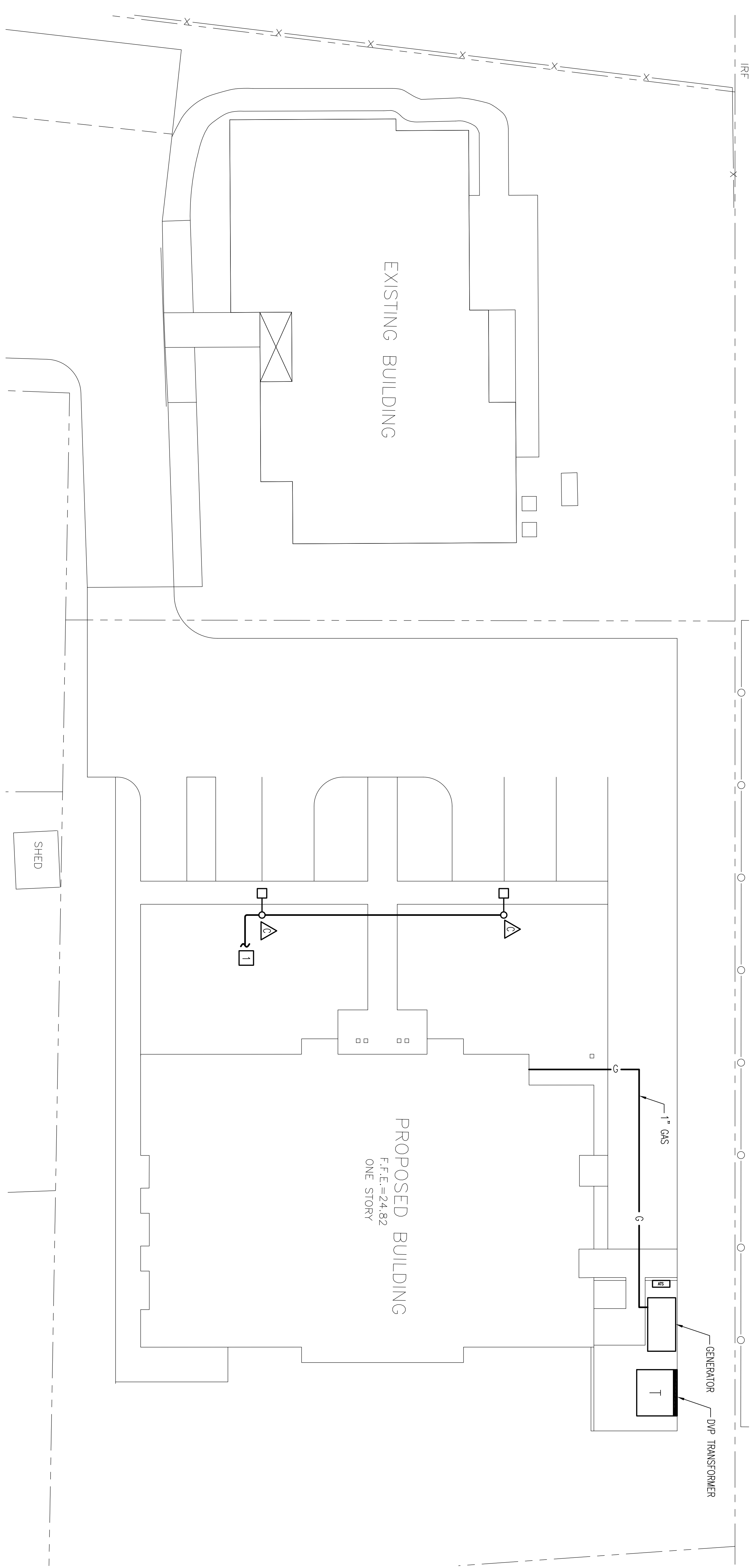

HUDSON + ASSOCIATES
ARCHITECTS
150 WEST QUEENS WAY SUITE 201
HAMPTON, VA 23669
(757) 722-1844

NOTES: (THIS SHEET ONLY)

1 CONNECT TO SWITCH INSIDE ENTRY. SEE SHEET E1.01 FOR CONTINUATION OF CIRCUIT.



□ □ □

□ □ □
BROGDEN LANE
ICE/MR HOME
FOR HNN C5B

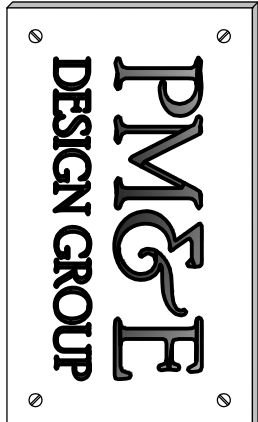

2712 SOUTHERN BLVD., SUITE 201
VIRGINIA BEACH, VIRGINIA 23462
PHONE: 757.233.3981
FAX: 757.233.8419
EMAIL: information@pmedg.com

□ □ □
SEPTEMBER 3, 2008



□ □ □
SITE PLAN - LIGHTING

REVISION DATE

GRAPHIC SCALE

SCALE: 1" = 30'-0"
10' 0' 10' 20'

⊕ SITE PLAN - LIGHTING
SCALE: 1" = 10'-0"

JOB NUMBER 0704
E.O.02